



# Raj Palace V

*A Quality Construction...*



Site : Plot No. 70, 71, In front of Revati Nagar Garden, PWD Gym,  
Near Pandav Polytechnic College, Omkar Nagar Road, Besa, Nagpur.

A Project by





Guard Room  
12'0" x 10'0"

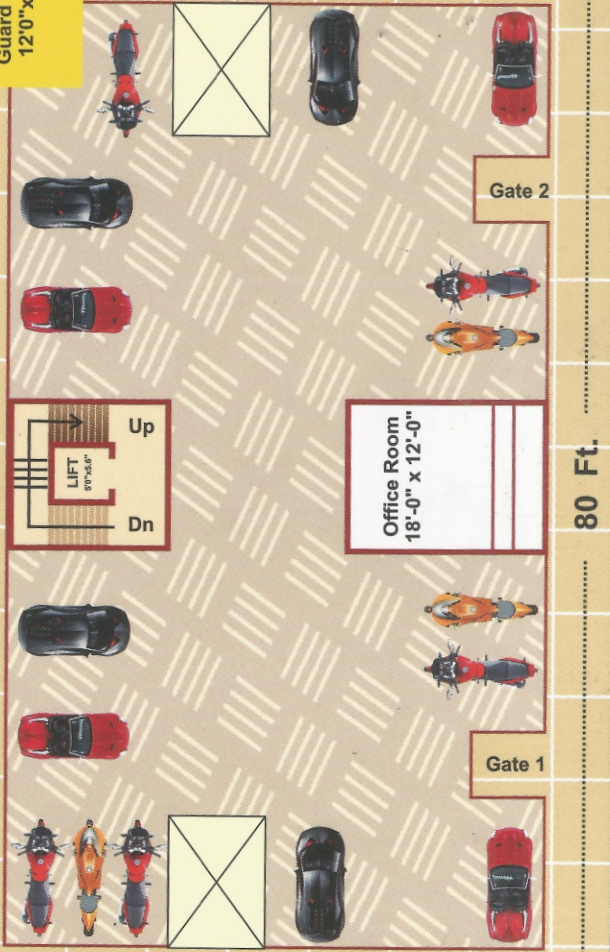

30 Ft. Road

Flat No.	Super Build up Area	Flat No.
101	1297.00 Sq. Ft.	102
201	1297.00 Sq. Ft.	202
301	1297.00 Sq. Ft.	302
401	1297.00 Sq. Ft.	402

## Highlights

- In front of Revati Nagar Garden
- In front of PWD Govt. Gym
- 0.4 mtr. from Besa Sq.
- 0.4 km. From Manish Nagar
- 1 km. From Omkar Nagar Sq.
- 5 km from Ajni Railway Station
- 5.5 km. From Main Bus Stop
- 6 km. From Air Port
- 8 km. From Zero Mile
- Near Big Bazaar, Lifestyle Interior Mall
- Central Bank of India



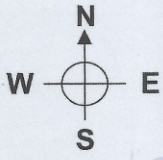

Balcony  
4'-0" x 11'-0"

Master Bedroom  
16'-0" x 11'-0"

Toilet  
5'-0" x 11'-0"

LED

Terrace/Balcony  
9'-3" x 9'-0"

Bedroom  
12'-0" x 10'-6"

Toilet  
4'-0" x 7'-0"

LED

Balcony 10'-6" x 3'-0"

Entry  
102,302  
S-B/UP  
1297.00 sq. ft.

Open to Sky

Lobby  
5'-0" x 5'-6"

Lift  
5'-0" x 5'-6"

Entry  
101,301  
S-B/UP  
1297.00 sq. ft.

LED

Master Bedroom  
10'-0" x 11'-0"

Toilet  
5'-0" x 11'-0"

LED

Bedroom  
12'-0" x 10'-6"

Toilet  
4'-0" x 7'-0"

LED

WD BAL. 2' x 6"

Balcony  
4'-0" x 11'-0"

Master Bedroom  
10'-0" x 11'-0"

Toilet  
5'-0" x 11'-0"

LED

Terrace/Balcony  
9'-3" x 9'-0"

Bedroom  
12'-0" x 10'-6"

Toilet  
4'-0" x 7'-0"

LED

Kitchen  
12'-8" x 10'-6"

Wash Area  
4'-0" x 10'-6"



# Specifications

- Structure** : RCC Framed structure.
- Walls** : RCC Frame work with External 6'.00" x Internal 4'.00" brick wall.
- Painting** : Internal Smooth Plaster wall with **Birla Putty** and Asian emulsion paint. External plaster with weathercoat **asian paint**.
- Flooring** : 2x2 **RAK** Fully flooring Vitrified Tiles in all Rooms & Balcony.
- Doors** : Decorative main doors with **Teak wood** & All Internal R.C.C. Frame with Flush Doors.
- Windows** : **Three Track** Aluminum sliding windows with glass & **net** with M. S. Safety Grill.
- Kitchen** : Modular Kitchen, Granite Platform with colour glazed tiles above Platform up to 2 ft. top with stainless steel sink .
- Toilets** : Designer Glazed - Dado Tiles on the full Walls. Standard **finolex** & **jaguar** fitting in All Bathrooms.
- Electric** : Concealed Electrification with **polycab** wiring, with **Legrand** Switches, Ac Point in Hall & Master Bedroom.
- P.O.P.** : P.O.P. in All Rooms.
- LIFT** : Lift Facility Available (**Kone**).
- OTHER** : Guard Room with Full Time Security, Rain Water Harvesting, **Solar water** in all Bathrooms, Luxuries Tarries in all flat. Steel Railing in Gallery, Tarries & Jeena, **Independent Parking** to each flat. **CCTV** facility available in Parking.

- ❑ Extra Charges for M.S.E.B., Network Meter, Transformer & Registration.
- ❑ Extra Work Will be Done Against Extra Payment in Advance.
- ❑ Taxes (Service Tax, Sales Tax & Vat)/ Incidental Charges Will be Borne By Purchaser As Applicable

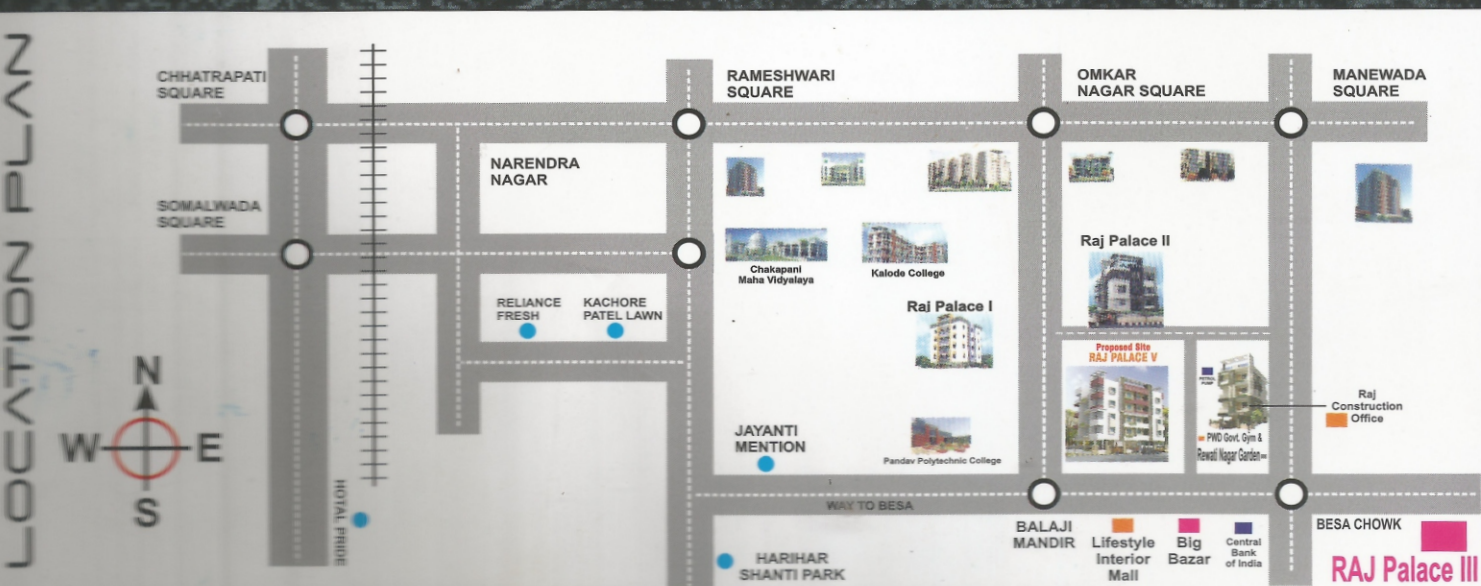

**For Booking Contact : 9767874853, 9175800505**